

If a camera is mounted on the cab protection;
Use pos 11 and decrease pos 10 correspondingly.

If working light is mounted on the cab protection;
Use pos 11 and decrease pos 10 correspondingly,
but double the amount.

Table 1

| Height (H) | Part no. pos 1 | Model | Qty. pos 2 | Qty. pos 4 | Qty. pos 5 | Qty. pos 6 | Qty. pos 10 | Qty. pos 11 | Total weight (app.) (kg) |
|------------|----------------|---------------------------|------------|------------|------------|------------|-------------|-------------|--------------------------|
| 410 | 377368 | With cut for exhaust pipe | 1 | 15 | 15 | 15 | 8 | 2 | 83 |
| | | No cut for exhaust pipe | 2 | 21 | 21 | 21 | 8 | 2 | 93 |
| 560 | 377371 | With cut for exhaust pipe | 1 | 15 | 15 | 15 | 12 | 3 | 102 |
| | | No cut for exhaust pipe | 2 | 21 | 21 | 21 | 12 | 3 | 112 |
| 710 | 377374 | With cut for exhaust pipe | 1 | 15 | 15 | 15 | 12 | 3 | 121 |
| | | No cut for exhaust pipe | 2 | 21 | 21 | 21 | 12 | 3 | 131 |
| 860 | 377377 | With cut for exhaust pipe | 1 | 15 | 15 | 15 | 16 | 4 | 140 |
| | | No cut for exhaust pipe | 2 | 21 | 21 | 21 | 16 | 4 | 150 |
| 1010 | 377380 | With cut for exhaust pipe | 1 | 15 | 15 | 15 | 16 | 4 | 159 |
| | | No cut for exhaust pipe | 2 | 21 | 21 | 21 | 16 | 4 | 169 |
| 1160 | 377383 | With cut for exhaust pipe | 1 | 15 | 15 | 15 | 16 | 4 | 178 |
| | | No cut for exhaust pipe | 2 | 21 | 21 | 21 | 16 | 4 | 188 |
| 1310 | 377386 | With cut for exhaust pipe | 1 | 15 | 15 | 15 | 20 | 5 | 198 |
| | | No cut for exhaust pipe | 2 | 21 | 21 | 21 | 20 | 5 | 208 |

| Pos | Ant. | Art.nr | Name | Benämning | Material | Dimension |
|-----|------|---------|-------------------------|-------------------------|-----------|-----------|
| 11 | Tbl1 | 377477 | Cable clamp for Ø6,5mm | Kabelklammer för Ø6,5mm | | |
| 10 | Tbl1 | 377478 | Plastic plug for Ø6,5mm | Plastplugg för Ø6,5mm | | |
| 9 | 4 | 179382 | Locking nut | Mutter lås | FZB | M10 |
| 8 | 4 | 179374 | Screw M6S | Skruv M6S | FZB | M10x30 |
| 7 | 8 | 178046 | Washer | Bricka | FZB | 10,5x20x2 |
| 6 | Tbl1 | 175695 | Locking nut | Mutter lås | FZB | M12 |
| 5 | Tbl1 | 175703 | Washer | Bricka | FZB | 13x24x2 |
| 4 | Tbl1 | 365281 | Screw M6SF-GF | Skruv M6SF-GF | F/J Volvo | M12x30 |
| 3 | 2 | 377299 | Handle | Handtag | | |
| 2 | Tbl1 | 377365 | Cover lid | Täcklock | | |
| 1 | 1 | Table 1 | Body | Stomme Hytttskydd HD | | |

Dimensions without individual tolerance acc. to SS-ISO 2768-1c

N.B. The copyright and ownership of this drawing including associated computer data are and will remain ours. They must not be copied, used or brought to knowledge of any third party without our prior permission. © Zetterbergs Industri AB, Sweden

| | | | | |
|---|---|----------------------|---|----------------------------|
| ZETTERBERGS | Ritad/Drawn 240119 | Godk./Approved NN | Skala/Scale 1:15 | Vikt/Weight See table 1 |
| Name Cab protection HD-series ZD4 Assembly | Benämning Hytttskydd HD-serien ZD4 Montering | Size A3 | Ersätter/Replace Ritn. nr/Drawing no. 377389 | |

Ingår i:

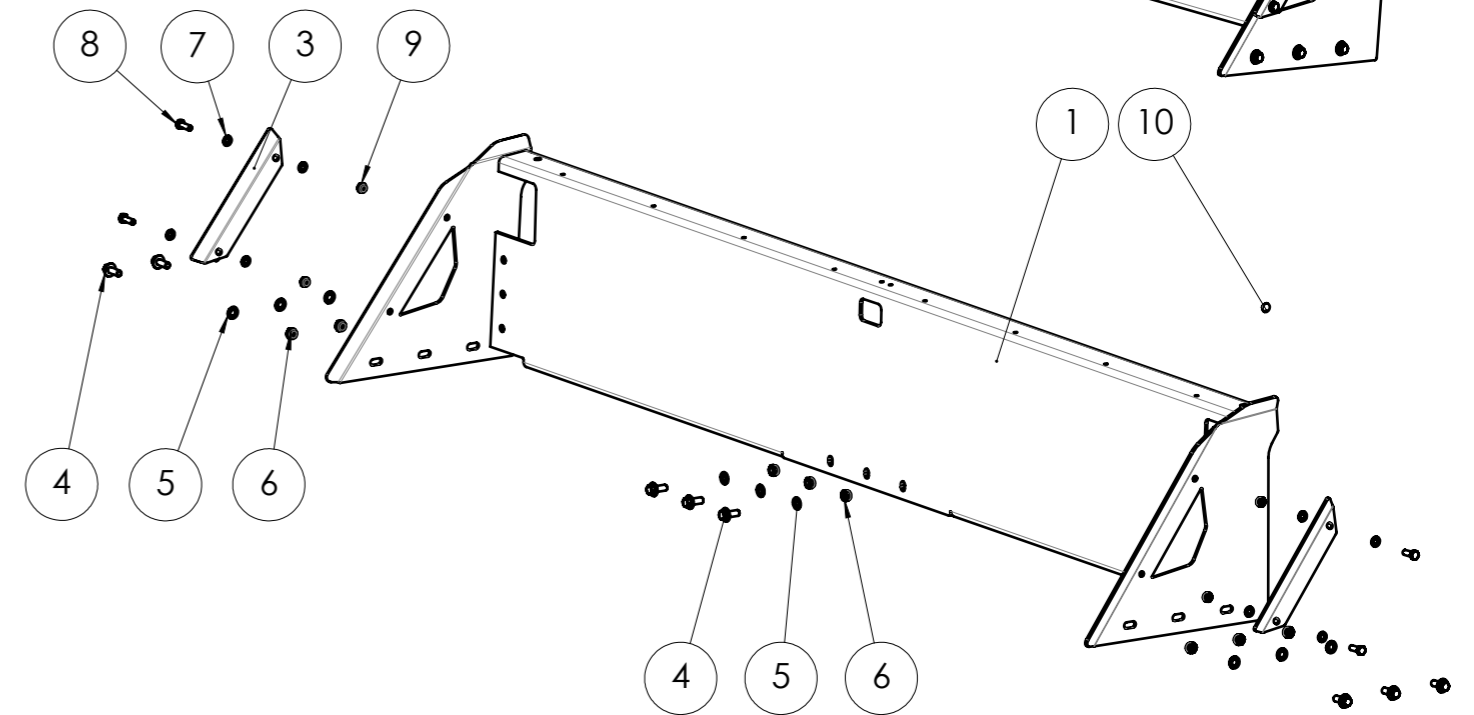
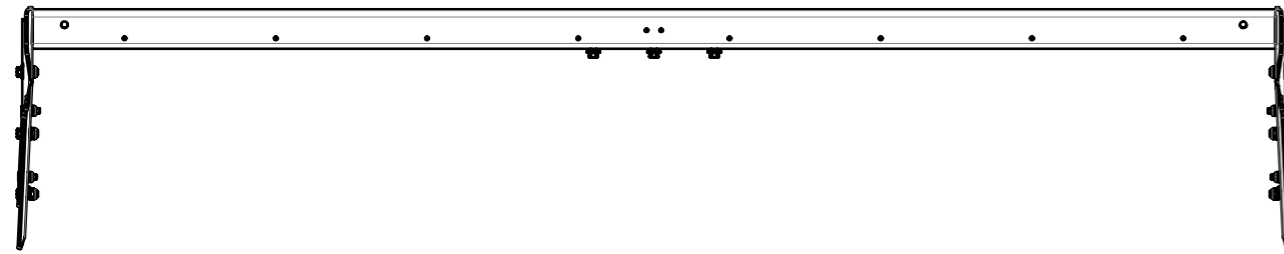
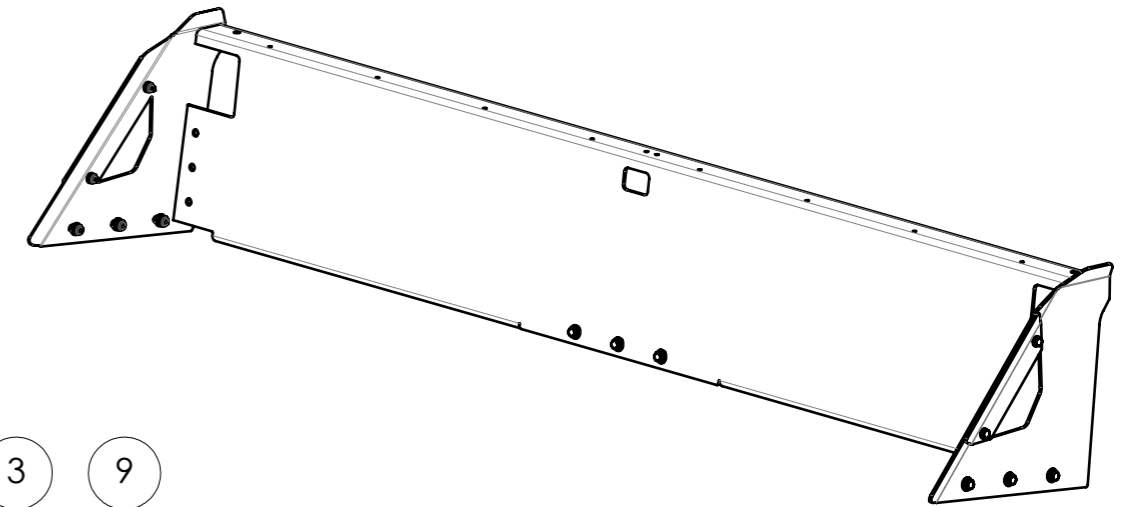
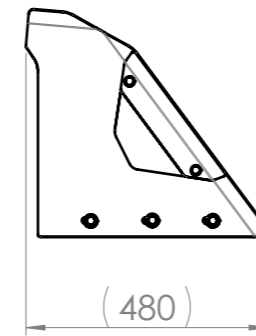
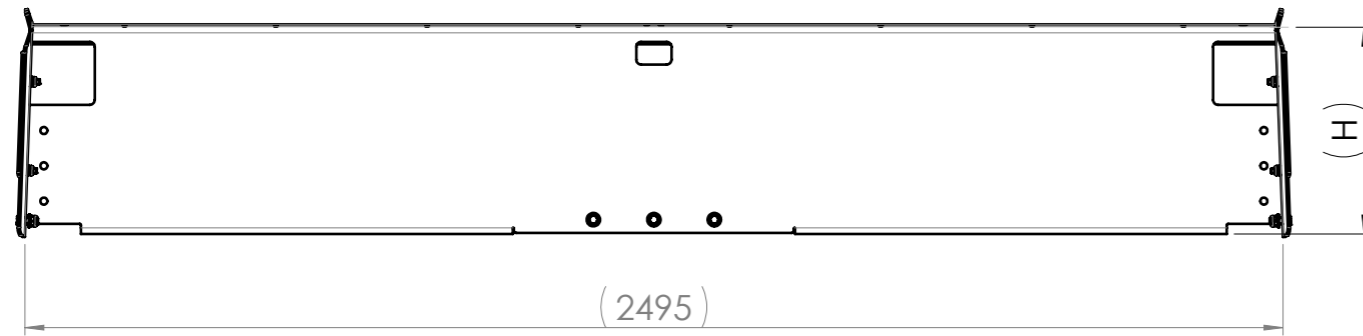

If a camera is mounted on the cab protection;
Use pos 2 and decrease pos 10 correspondingly.

If working light is mounted on the cab protection;
Use pos 2 and decrease pos 10 correspondingly,
but double the amount.

Table 1

| Height (H) | Part no. pos 1 | Qty. pos 10 | Qty. pos 2 | Total weight (app.) (kg) |
|------------|----------------|-------------|------------|--------------------------|
| 410 | 377458 | 8 | 2 | 65 |
| 560 | 377461 | 12 | 3 | 83 |
| 710 | 377464 | 12 | 3 | 101 |
| 860 | 377467 | 16 | 4 | 118 |
| 1010 | 377470 | 16 | 4 | 136 |
| 1160 | 377473 | 16 | 4 | 154 |
| 1310 | 377476 | 20 | 5 | 172 |

| 10 | Tbl1 | 377478 | Plastic plug for $\varnothing 6,5\text{mm}$ | Plastplugg för $\varnothing 6,5\text{mm}$ | | |
|-----|------|---------|---|---|-----------|-----------|
| 9 | 4 | 175695 | Locking nut | Mutter lås | FZB | M10 |
| 8 | 4 | 178046 | Screw M6S | Skruv M6S | FZB | M10x30 |
| 7 | 8 | 179374 | Washer | Bricka | FZB | 10,5x20x2 |
| 6 | 9 | 175703 | Locking nut | Mutter lås | FZB | M12 |
| 5 | 9 | 179382 | Washer | Bricka | FZB | 13x24x2 |
| 4 | 9 | 365281 | Screw M6SF-GF | Skruv M6SF-GF | F/J Volvo | M12x30 |
| 3 | 2 | 377299 | Handle | Handtag | | |
| 2 | Tbl1 | 377477 | Cable clamp for $\varnothing 6,5\text{mm}$ | Kabelklammer för $\varnothing 6,5\text{mm}$ | | |
| 1 | 1 | Table 1 | Body | Stomme | | |
| Pos | Ant. | Art.nr | Name | Benämning | Material | Dimension |

Dimensions without individual tolerance acc. to SS-ISO 2768-1c

N.B. The copyright and ownership of this drawing including associated computer data are and will remain ours. They must not be copied, used or brought to knowledge of any third party without our prior permission. © Zetterbergs Industri AB, Sweden

| | | | | | |
|---------------------------|--|----------------------|----------------|---------------|----------------------|
| ZETTERBERGS | | Ritad/Drawn | Godk./Approved | Skala/Scale | Vikt/Weight |
| | | 240120 | NN | 1:15 | See table 1 |
| Name | | Benämning | | Size | Ersätter/Replace |
| Cab protection HDR-series | | Hyttskydd HDR-serien | | A3 | Ritn. nr/Drawing no. |
| ZD4 | | ZD4 | | | |
| Assembly | | Montering | | 377389 | |